

Inventory Number 177-5400-173

SELGEN

REGISTER OF HISTORIC KANSAS PLACES--COVER SHEET

Name of Property Bethany Place

Location 833-835 Polk
(street and number)

Topeka, Kansas
(city, town, or vicinity location)

(legal description)

SHAWNEE
(county)

Owner of Property Episcopal Diocese of Kansas

833-835 Polk
(street and number)

Topeka, Kansas 66612
(city, town, county)

National Register status:

date approved for nomination to the National Register by Kansas Historic Sites Board of Review November 17, 1978

date entered in National Register _____

Description: Bethany Place consists of two stone structures, the old wash house and carriage house, associated with the College of the Sisters of Bethany. Both are 1½ story structures detailed with bracketed wood cornices. Both have been converted to serve other functions

Significance: The two stone structures at Bethany Place are the only surviving remnants of the buildings that comprised the College of the Sisters of Bethany, a notable educational institution for women in Topeka (and Kansas) chartered in 1871. Now the Bishop's Residence

Form prepared by Julie A. Wortman date February 21, 1979

This property was approved for listing in the Register of Historic Kansas Places by the Kansas Historic Sites Board of Review on November 17, 1978. I hereby certify that this property is included in the Register of Historic Kansas Places.

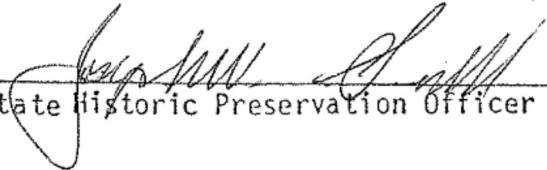
State Historic Preservation Officer

2-21-79
Date

DESCRIPTION:

and the old stable was moved to its present location. The boundaries of the Register of Historic Kansas Places property coincide with the legal boundaries of the property except that these two structures are the only two structures considered historic for the purposes of this nomination.

SIGNIFICANCE:

and Bishop's Office for the Episcopal Diocese of Kansas, these two structures were the original stable and washhouse, respectively, of the College and their original portions were built in 1875.

HISTORIC PROPERTY INFORMATION FORM

1. Name and location of the property. "Bethany Place", 833-35 Polk Street, Topeka, Kansas (Diocesan Headquarters--Office)	
2. Who owns the property? Episcopal Diocese of Kansas address: Bethany Place, 833-35 Polk Street Topeka, Kansas (Diocesan Headquarters)	3. How is the property used? Office, Headquarters of the Diocese of Kansas Has it always been used for this? Originally the <u>wash house/laundry</u> for the College of the Sisters of Bethany, and Epis- copal School for Girls.
4. When was the structure built? (explain how you determined the date of construction) 1874. Address of Bishop Vail to the Convention of the Diocese of Kansas 1875, page 26 of the Convention Journal, 1875, and page 166, Plenteous Harvest, B. M. Taylor, Josten', Topeka, 1973.	
5. Do you know the name of the original owner? (If so, please include.) Original 20 acres donated to the Episcopal Church by Topeka Association for a girls school.	6. Do you know who built the structure? (If so, please include.) College of the Sisters of Bethany. (John H. Haskell, Architect)
7. Is an abstract available? If so, where? Yes, in the Diocese of Kansas safety deposit box at Capital ^{FEDERAL} Savings, Topeka, Kansas.	
8. Does the property look the same today as it did when it was first constructed? (Tell what, if anything, has been changed. If you know when changes were made, that information would also be helpful.) Converted to residential use in 1928, porch added to the south side, kitchen and garage to the west on the lower floor. Second floor sleeping porch ^{ON THE SOUTH} on the west, a bedroom and bath. A maids room was also added along with the garage. The interior was partitioned into individual rooms, and the walls of the living room/dining area were paneled in pine. Used as office since 1959 and no changes have been made. Additions, are of the same native stone as the original structure.	
9. Why is this property important? Bethany Place and its two buildings is what remains of the College of the Sisters of Bethany. Is a distinct facet of the early history and development of Topeka, and also of Kansas. The buildings are elegant examples of the architecture of the period and embody style and characteristics of an archetypal type. (See attached page for further statement of significance, and references.)	
10. Where did you find out about the property's history and importance? Through the records of the College of the Sisters of Bethany and the history and records of the Episcopal Diocese of Kansas. (See attached page for references.)	

11. Please sketch a simple map showing the property and its relationship to surrounding structures and streets, providing a north arrow.

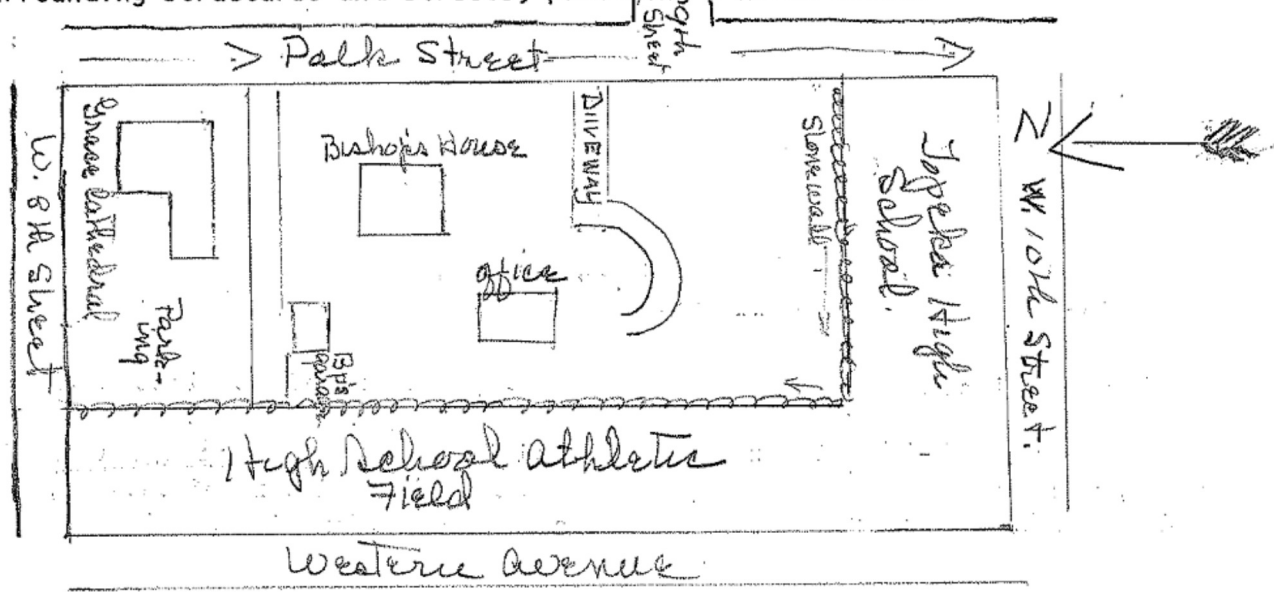

12. If there are other properties nearby, what are they like? Do they date from the same period, look the same, have similar functions, etc.?

Grace Episcopal Cathedral is on the north, English Gothic style, native stone, building started in 1908, completed 1917, except for towers which were completed in 1955.
 Topeka, High School on the south, red brick English Gothic, built in 1929 or early 30's.
 On the west the High School athletic field, screened by a planting of trees and shrubs on the Bethany Place property
 On the east there are recently built apartment buildings--built in the past ten years and some residences converted to apartments.

Please enclose at least one photograph of the property.

Your name and address:

Date:

Mrs Arthur W. Baum, Historiographer
Diocese of Kansas, Bethany Place
Topeka, Kansas 66612

August 18, 1978



DIocese OF KANSAS

BETHANY PLACE

TOPEKA

66612

THE RT. REV. EDWARD C. TURNER, D.D.
BISHOP

Additional Statement of Significance:

The original 20 acres, known as Bethany Square, were donated to the Episcopal Church by the Topeka Association. The last legislative act of the Territorial Legislature on February 2, 1861 was the passage, over Gov. Medary's veto, of a new act of incorporation for the "Episcopal Female Seminary of Topeka". In 1871 the name of the school was changed to "The College of the Sisters of Bethany".

It was from this Bethany Square that Grace Cathedral was given land by the Trustees of the College,

References: Giles, F. W., "Thirty Years in Topeka" (George W. Crane, Topeka, 1886), pp 183, 185

Diocesan Journals, 1861, p 21; 1875, p 26; 1889, p 29; 1918, p 26

Minutes, Board of Trustees, Episcopal Female Seminary, April 2, 1861

Minutes, Board of Trustees of Bethany College, Dec. 12, 1928

Letter, Chester W. Woodward, President, Topeka School Board to the Trustees of Bethany College, Nov. 28, 1927

Taylor, B. M. "Plenteous Harvest" (Josten's, Topeka, 1973) pp 130, 144, 163, 165, 166, 170, 173

