

United States Department of the Interior
National Park Service

**National Register
Listed
10/04/2017**

National Register of Historic Places Registration Form

This form is for use in nominating or requesting determinations for individual properties and districts. See instructions in National Register Bulletin, *How to Complete the National Register of Historic Places Registration Form*. If any item does not apply to the property being documented, enter "N/A" for "not applicable." For functions, architectural classification, materials, and areas of significance, enter only categories and subcategories from the instructions. **Place additional certification comments, entries, and narrative items on continuation sheets if needed (NPS Form 10-900a).**

1. Name of Property

Historic name Topeka Cemetery Historic District (Boundary Expansion)

Other names/site number KHRI #177-3963; Topeka Cemetery Mausoleum Row (KHRI #177-5400-01267)

Name of related Multiple Property Listing N/A

2. Location

Street & number 1601 SE 10th Avenue

--

 not for publication

City or town Topeka

--

 vicinity

State Kansas Code KS County Shawnee Code 177 Zip code 66607

3. State/Federal Agency Certification

As the designated authority under the National Historic Preservation Act, as amended,
I hereby certify that this x nomination request for determination of eligibility meets the documentation standards for registering properties in the National Register of Historic Places and meets the procedural and professional requirements set forth in 36 CFR Part 60.
In my opinion, the property x meets does not meet the National Register Criteria. I recommend that this property be considered significant at the following level(s) of significance:
 national statewide X local Applicable National Register Criteria: X A B X C D

See file.
Signature of certifying official/Title Patrick Zollner, Deputy SHPO Date _____

Kansas State Historical Society
State or Federal agency/bureau or Tribal Government

In my opinion, the property X meets does not meet the National Register criteria.
Signature of commenting official _____ Date _____

Title _____ State or Federal agency/bureau or Tribal Government

4. National Park Service Certification

I hereby certify that this property is:
 entered in the National Register determined eligible for the National Register
 determined not eligible for the National Register removed from the National Register
 other (explain:) _____

Signature of the Keeper _____ Date of Action _____

Topeka Cemetery (Boundary Expansion)
Name of Property

Shawnee County, Kansas
County and State

5. Classification

Ownership of Property
(Check as many boxes as apply.)

Category of Property
(Check only **one** box.)

Number of Resources within Property
(Do not include previously listed resources in the count.)

<input checked="" type="checkbox"/>	private
<input type="checkbox"/>	public - Local
<input type="checkbox"/>	public - State
<input type="checkbox"/>	public - Federal

<input type="checkbox"/>	building(s)
<input checked="" type="checkbox"/>	district
<input type="checkbox"/>	site
<input type="checkbox"/>	structure
<input type="checkbox"/>	object

<u>Contributing</u>	<u>Noncontributing</u>	
9		buildings
2		sites
2	2	structures
2	3	objects
15	5	Total

Number of contributing resources previously listed in the National Register

10

6. Function or Use

Historic Functions
(Enter categories from instructions.)

FUNERARY: CEMETERY

FUNERARY: MORTUARY

DOMESTIC: SINGLE DWELLING

AGRICULTURE: ANIMAL FACILITY

Current Functions
(Enter categories from instructions.)

FUNERARY: CEMETERY

FUNERARY: MORTUARY

7. Description

Architectural Classification
(Enter categories from instructions.)

OTHER: VERNACULAR

LATE 19TH & 20TH CENTURY REVIVALS:

CLASSICAL REVIVAL

OTHER: RURAL CEMETERY

OTHER: LAWN-PARK CEMETERY

Materials
(Enter categories from instructions.)

foundation: STONE

walls: STONE

BRICK

roof: ASPHALT

other: N/A

Topeka Cemetery (Boundary Expansion)
Name of Property

Shawnee County, Kansas
County and State

Narrative Description

Summary

This nomination for the Topeka Cemetery Historic District at 1601 Southeast 10th Avenue in Topeka, Kansas amends the information for the Topeka Cemetery Mausoleum Row, listed in the National Register on April 25, 2001. This nomination amends the original listing to include the entire cemetery and extant buildings historically associated with the cemetery. The cemetery is nominated to the National Register of Historic Places under Criterion A as locally significant in the area of Exploration and Settlement for its association with early Topeka. The cemetery is also significant under Criterion C in the area of Architecture for its planned landscape design as a rural and lawn-park cemetery.

The Topeka Cemetery, the oldest chartered cemetery in Kansas, is located on 77.76 acres in the northeast corner of Section 5, Township 12, Range 16 East at 1601 Southeast 10th Avenue in Topeka, the capital city of Kansas, in Shawnee County (Figure 1). The roughly rectangular cemetery is located in the eastern portion of Topeka, bounded on the north by Southeast 10th Avenue, on the east by Southeast California Avenue, on the south by a highway ramp and on the west by the property line and Freedom Valley Park (Figure 2 & Boundary Map). The nominated property includes the contributing cemetery grounds of historic roads and paths, monuments and memorials, a historic farmstead and office complex, a pet cemetery and 16 mausolea (Figure 3). Ten of the mausolea, which are located in the north central portion of the cemetery, were listed in the National Register in 2001. Non-contributing elements include a 2003 garden chapel, columbarium and three memorials.

The cemetery site, consisting of the landscape of monuments and interments, is intersected with asphalt paths and roads. The site slopes from a high point in the north central portion steeply down to the northwest and gently to the northeast, east and south. A modern metal fence runs along the east and north boundaries. Access into the cemetery is from two entrances on SE 10th Avenue and one southeast entrance on SE California Avenue. Chartered on 45 acres in 1859, the cemetery was expanded south in 1915 and today contains approximately 35,000 interments. The cemetery continues to accept interments but retains its historic integrity in location, design, setting, materials, workmanship, feeling and association.

Elaboration

Setting

The Topeka Cemetery, located outside of the city limits until the area was annexed in 1958, is now located in a residential neighborhood. Modest houses built mostly in the 1950s and 1960s fill the streets north and west of the cemetery. Southeast California Avenue, the cemetery's east boundary, leads south past I-70 to dense neighborhoods and supporting commercial development. The cemetery lost a tract of its southernmost land in 1963 to the construction of ramps connecting California Avenue to Highway I-70.¹ Freedom Valley Park, dedicated in 1984, took 31.8 acres in the southwest portion of the cemetery. The park acts as a buffer between the south portion of the cemetery and Interstate Route I-70. The quiet cemetery is open sunrise to sunset every day.

Elaboration

Topeka Cemetery measures approximately 1298 feet at its widest east-west point on SE 10th Avenue and approximately 3036 feet at its longest north-south point along SE California Avenue. The cemetery's original 45 acres in the north portion feature winding roads, moderately hilly terrain and several burial sections that are elliptical or irregularly shaped, elements all consistent with rural cemetery design (Photos 14, 16, 17, 18, 19). Grave markers dating from the mid-1850s to the present are located within the loops formed by the roads, as well as between the roads and the cemetery's outer boundaries. Section 1, a central circular plot, is located on the highest elevation within the cemetery (Figure 2). The Sweet family plot, consisting of a large obelisk and

¹ According to the Kansas Department of Transportation, the highway ramps for California Avenue were built in 1963.

Topeka Cemetery (Boundary Expansion)

Shawnee County, Kansas

Name of Property

County and State

several smaller markers, is located in the center of the section (Photo 15). Several dozen additional headstones and markers are also located within the section. Section 1 is surrounded by a curving quadrant of burial sections. The elevation drops suddenly to the west and northwest. Mausoleum Row (NR April 25, 2001) and the Hurley Monument are located along curving paths on the west edge of the cemetery. The pet cemetery (Photo 13) and Crane farmstead (Photo 4) are located west and northwest of these areas, downhill from the rest of the cemetery. The Battle of the Blue Civil War monument and veterans plat are located just north of Section 1. Sections north of the monument slope slightly downward and are irregularly shaped, defined by winding roads.

The Jewish Cemetery, one acre owned by Temple Beth Sholom, is located within two sections that separate the north and south portions of the cemetery (Photo 12). The rectangular sections in the east central portion of the cemetery were platted in 1873. Most of the approximately 90 markers here are substantial, many with Hebrew inscriptions and religious Jewish symbols, such as the Star of David, Priestly Blessing or a menorah. Older markers within the sections are oriented to the east, but later stones face the cemetery roads. Identifiable markers in the Jewish section date from 1874 to the present.

Forty-five acres were added to the south portion of the cemetery in 1915. This area features a regular grid of roads surrounding rectangular sections with circular mausoleum plots at some intersections (Photos 20, 21, 22). Several modern monuments and structures are located in the southernmost sections, built between 1968 and 2003.

Markers and monuments throughout the Topeka Cemetery are arranged either individually or within family plots. Markers within the oldest sections are representative of late 19th- to early-20th-century cemetery headstones, ranging from simply carved stones to elaborate markers abundant with iconography. Many plots have a large monument inscribed with the family name surrounded by smaller stones for individual family members. Most markers are oriented to paths or to the large monuments, rather than directionally. As one moves to the newer portions of the cemetery, monuments become simpler, often with lower profiles.

This nomination includes 13 contributing resources—two sites (the cemetery and pet cemetery), nine buildings (farmstead buildings and mausolea) and two structures (memorials). The circa 1855 Franklin Crane house, the circa 1860 office/carriage house building and the circa 1890 barn are clustered in the northwest portion of the cemetery. A historic war memorial—the Battle of the Blue Civil War Memorial—was installed next to the cemetery's veterans section in 1895. The massive Hurley monument, a granite obelisk more than 40 feet tall, was purchased with contributions from Atchison, Topeka & Santa Fe Railroad employees and installed in front of Mausoleum Row in 1912. A pet cemetery was added to the west edge of the grounds in 1933.

The cemetery has six non-contributing structures—three memorials, one garden chapel, one columbarium and the wrought iron fence on Southeast 10th Avenue and California Avenue.

Individual contributing resources include:

**1. Franklin Crane House (ca. 1855, ca. 1885)
KHRI #177-5400-00101**

39.042310,-95.655160

The two-and-a-half-story house (Photo 1) is of built native stone and has an irregular hipped roof. Most windows are six-over-one double-hungs. The west elevation has a central window with a pieced stone arched header, a central hipped dormer and a south hipped porch with stone supports. The south elevation has a west two-story bay window, a central stone wall supporting a second-story deck and a hipped dormer. The east elevation has a south stairway leading from ground level to the second story, a central enclosed first-story shed porch and an east gable wall dormer. The north elevation shows three extensions protruding forward from the east to west. A one-story hipped bay extends from the west portion, fronted by a wood lattice fence.

Topeka Cemetery (Boundary Expansion)
Name of Property

Shawnee County, Kansas
County and State

According to Franklin Crane's diary, the house was begun in 1855. Architect Seymour Davis came to Kansas to work after 1880 and likely expanded the house to its current configuration prior to 1885. Davis served as the state architect 1893-1895. The first story of the house serves as the cemetery's office. The upper stories are rented as living quarters.

2. Topeka Cemetery Office & Carriage House (ca. 1860)
KHRI #177-3961

39.042172,-95.655490

The two-story stone building (Photo 2) has a central brick chimney, stone corner quoins, stone lintels and wood sills on two-over-two windows. A one-story frame porch wraps around the building's northeast corner. The north gable-front elevation is three bays wide with an east entrance door and windows in the first and second stories of the bays. A boarded over window opening is in the gable peak. The east elevation has a north door next to a first-story window. A south carriage opening has an arched brick header. A central first-story door leads to the second story, which has three windows. The south elevation has two first-story windows, a central hay door, a second-story window and a gable window, all boarded over. A one-story west shed has a south carriage door with an arched brick header. The west elevation of the west shed has two boarded over windows.

The circa 1860 building originally had an office and vault in the north first story and living space in the north second story. The south portion had a carriage house in the first story and a storage loft in the second story. The building is used today as a maintenance shed.

3. Topeka Cemetery Barn (ca. 1890)
KHRI #177-3962

39.041772,-95.655519

The two-story rubble limestone barn (Photo 3) has an original east gable-front section and a one-and-one-half-story west shed addition. Openings have wood lintels and sills. The north elevation has two sliding doors in first story, second-story hinged doors and a boarded over opening in the gable peak. The east elevation has two central window openings, now boarded over. The south elevation configuration matches the north elevation. The west elevation has three boarded over window openings.

The circa 1890 building likely served as a barn for the cemetery, the Crane family horses and storage. The building is now used for storage.

4. East Retaining Wall & Driveway Remnant (ca. 1920)
KHRI #177-3651

39.041458,-95.650952
Between Sections 47 & 48

The cemetery's eastern boundary along California Avenue partially consists of a concrete retaining wall. This wall is interrupted by a former concrete driveway between Sections 47 and 48. The concrete wall, which measures approximately two feet in height, was poured in standardized horizontal sections with a central stamped rectangle and a concrete cap. The wall begins at the section line between Sections 49 and 65 and extends south to the driveway approximately 270 feet. The former driveway is 20 feet wide and has been formerly disconnected from California Avenue; along the north and south edges of the driveway the wall continues about 25 feet (Figure 10). The wall continues south along the east edge of Section 47 for approximately 90 feet.

In 1996 a wrought iron fence was added to the top of the wall, continuing along the entire eastern and northern boundaries. This fence is not contributing.

5. North Entry Gate (1938)
KHRI #177-4201

39.044210,-95.653639
North end of Section 97

The main north entrance (Photo 23) to the cemetery consists of a pair of curved stone walls with outer and inner stone pillars and a pair of wrought iron gates. Plaques on the outer pillars read: TOPEKA/ CEMETERY/ ESTABLISHED 1859/ BY/ DR. FRANKLIN L. CRANE.

Topeka Cemetery (Boundary Expansion)
Name of Property

Shawnee County, Kansas
County and State

The cemetery's stone main gate was built in 1938, designed by Topeka stonemason Adam Christie.² The wrought iron fence was added in 1996.

6. Battle of the Blue Civil War Memorial (1895)
KHRI #177-3651

39.041777,-95.652685
Section 21

The granite sculpture of a Civil War soldier at parade rest is six feet tall atop a 12-foot base (Photo 6). The base is inscribed: Erected by G.G. Gage/to the memory of/his comrades who fell at/The Battle of the Blue/Oct. 22, 1864/by the blood of these heroes/and their compatriots this/great republic was/made to live. And: 2nd Regiment KSM/from Shawnee County/commanded by/Col. G.W. Veale/attached to the army/of the frontier. A square of 14 veteran markers is adjacent east of the monument and ten rows of veteran markers are adjacent northeast. A concrete flagpole, installed in 2005, stands north of the monument.

The monument was unveiled in 1895 at a cost of \$5000. It was erected by G.G. Gage in honor of his comrades who fell during the war.³

7. Hurley Monument (1912)
KHRI #177-3964

39.041634,-95.654739

The Vermont granite obelisk (Photo 5) is 40'7" tall. It sits on a square stone slab with two stone ledges. The monument's inscription reads, "JAMES EDWIN HURLEY/ JUNE 1, 1860-AUG, 16, 1910/ A TRIBUTE TO HIS MEMORY/ FROM THE EMPLOYEES OF/ THE ATCHISON, TOPEKA/ AND SANTA FE RAILWAY/ COMPANY. A stone base in front of the monument once held a brass urn, now damaged and stored off-site. A stone bench is located southeast of the monument with "HURLEY" inscribed on it.

James Edwin Hurley, the general manager of the Atchison, Topeka & Santa Fe Railroad, died in August 1910. Railroad employees made donations toward this monument, most between 10 cents and one dollar. The monument was erected in May 1912 at a cost of \$7800.⁴

8. Pet Cemetery (ca. 1933)
KHRI #177-3965

39.040526,-95.655694

The pet cemetery (Photo 13), located on the west edge of the Topeka Cemetery south of the farmstead, contains around 360 plots that measure 2 ½ by 5 feet. Markers are very low or flat.

The pet cemetery was added to the grounds around 1933. W.R. Carrie, then-superintendent of the cemetery, inaugurated the pet plot. A woman reportedly wanted to bury her pet dog in the regular family lot. An animal could not be buried in the regular cemetery, so Carrie placed the animal in a grave behind the cemetery's barn. Subsequent pet burials followed.⁵

Mausolea

A row of ten mausolea was built between 1887 and 1913 into a hillside on the west side of the cemetery (Topeka Cemetery Mausoleum Row, listed April 25, 2001 in the National Register of Historic Places, KHRI #177-5400-01267). There are also six freestanding mausolea built between 1916 and 1930 scattered throughout the southern portion of the cemetery.

9. Parker Mausoleum (1921)
KHRI #177-3966

39.041084,-95.654793

The rusticated granite Classical Revival mausoleum (Photo 7) sits on a smoother stone base and measures 8-1/2 feet wide and 10 feet deep. The stacked gable roof has "1921" carved in gable peak and "PARKER" on

² "Thousands Due to Visit Oldest Cemetery May 30," *Topeka State Journal*, 29 May 1939.

³ "Honor The Dead," *Topeka State Journal*, 30 May 1914.

⁴ "The Hurley Monument," *Santa Fe Employes' Magazine*, March 1912, 54.

⁵ "Burial Ground Here May be only One of Kind in State," *Topeka State Journal*, 18 February 1950.

Topeka Cemetery (Boundary Expansion)
Name of Property

Shawnee County, Kansas
County and State

the entablature. Pair of bronze northeast doors has upper grates, central plaques and lower panels. The door's bronze plaques read: "IN MEMORY/ OF/ ROLLA J. PARKER" and "ERECTED BY/ HIS/ RAILWAY ASSOCIATES". A southwest stained glass window protected by metal grill is broken. Central vents are located on north and south sides.

The mausoleum was built for Rolla Jabish Parker, superintendent of the Atchison, Topeka & Santa Fe Railway. Parker was born in 1857 in Roscoe, Minnesota. He began working for the Chicago, Milwaukee & St. Paul Railway in 1872. He began working for the Topeka, Atchison & Santa Fe Railway in 1887, rising to general superintendent in Topeka in 1910. He died April 1, 1921.

10. Dagg Mausoleum (1930)
KHRI #177-3967

39.041172,-95.654857

The rusticated granite Classical Revival mausoleum (Photo 7) has a granite base and measures 10 feet wide and 11 feet deep. The stacked gable roof has "1930" carved in the gable peak and "DAGG" on the entablature. Smooth granite with decorative motifs surround a pair of bronze east doors, which have upper grates and lower panels. A west window is covered with Plexiglas. Vents are located on north and south sides.

The mausoleum built for Caleb Dagg, treasurer and director of the Federal Land Bank of Wichita, Kansas. Born in 1859 in Ireland, Dagg came to the United States in 1884 with his parents. He served as vice-president of the First National Bank of Dighton in Lane County and president of the First State Bank of Healy before being appointed treasurer and elected a director of the Federal Land Bank of Wichita, one of the largest financial institutions in the country in the early 1900s.

11. Stansfield Mausoleum (1916)
KHRI #177-3968

39.040159,-95.652990
Section 77

The mausoleum (Photo 8) is designed in the Egyptian Revival style, with smooth stone block walls, a flat roof and a curved cornice with a central winged orb guarded by cobras on the east entrance. The building measures 11 feet wide and 13 feet deep. Columns with acanthus leaf capitals surround the east entrance, which has double bronze doors with upper lights and lower panels. The entablature has raised letters that read, "19 STANSFIELD 16." Small vents are in the north and south walls. A metal grate covers a small west stained glass window.

The mausoleum was built in 1916 for the Stansfield family.

12. Hurd Mausoleum (1916)
KHRI #177-3970

39.038668,-95.651939
Island at junction of Sections 80, 81, 82, 83

The Classical Revival rusticated granite mausoleum (Photo 9) sits on a base with a smooth water course, located on a median island. The structure measures 12 feet by 12 feet. The stacked gable roof has "1916" carved in the gable peak and "A.A. HURD" on the smooth entablature. The pair of north bronze doors has upper grates and lower panels with an AHA monogram. A south window opening has a metal grill. Four bronze vents are on the east and west sides.

The mausoleum was built for A.A. Hurd, a prominent Topeka attorney. Hurd, born in 1849 in Lafayette, Illinois, moved to Abilene to practice law and to serve as the first city clerk there. He later served as Great Bend's first mayor. He moved to Topeka as an attorney for the Santa Fe Railway.

13. Fulton Mausoleum (1921)
KHRI #177-3971

39.038159,-95.651971
Island at junction of Sections 82, 83, 88, 90

The Classical Revival mausoleum (Photo 10) is built of rusticated granite blocks on a base that measures 12 feet by 12 feet. The mausoleum is located on a median island. The upper portion of the stacked gable-front north elevation is smooth stone. The gable peak has "1921" carved in it and "S.T. FULTON" in the entablature. The north pair of bronze doors has upper grills and lower panels. A metal grill fronts a small south window. East and west elevations have three small bronze vents.

Topeka Cemetery (Boundary Expansion)
Name of Property

Shawnee County, Kansas
County and State

The mausoleum was built for Samuel T. Fulton, born in Topeka in 1866, who began his railroad career at the age of 13 as a messenger boy in the telegraph office of the Kansas Pacific Railway at Topeka. He later became assistant to Benjamin Winchell, the president of the Chicago, Rock Island & Pacific Railway and the western manager of the Railway Steel Spring Company. Fulton was later appointed general sales agent and then western manager for the Railway Steel Spring Company.⁶

14. Battey Mausoleum (1921)
KHRI #177-3969

39.038184,-95.652969

Island at junction of Sections 83, 90, 91, 98

The Classical Revival mausoleum (Photo 11) is built of rusticated granite blocks on a base that measures 13 feet by 13 feet. The mausoleum is located on a median island. The gable-front north elevation has "1921" in the gable peak and "BATTEY" in the entablature. The north pair of bronze doors has a smooth stone surround above two steps. Doors have upper lattice and lower panels. A metal grate fronts the small south window. East and west elevations have four small bronze vents.

The mausoleum was built for Richmond T. Battey, president of Marion County Bank in Florence, Kansas. Battey, born in 1849 in Rhode Island, came to Kansas with his parents in 1858. In 1868 he established Topeka's first sheet iron cornice company. He moved to Florence, Kansas in 1871 and ran a hardware store there, eventually joining the Marion County Bank of Florence as cashier and later as president.

Non-contributing structures include:

15. Nancy Hummer Memorial Fountain (1968)
KHRI #177-3972

39.036234,-95.651751

Section 95A

A wide concrete pad surrounds the rectangular fountain (Figure 11) containing five jets that spray water upward. Stone benches are placed on the south and east sides of the fountain. The fountain originally had sculptures in the corners and larger sprays.

The memorial fountain was built and dedicated in 1968 in honor of Nancy Louise Hummer by her parents, Dana and Louise Hummer. The Hummers were philanthropists, and both members of the Topeka Cemetery Board of Directors.

16. Vietnam Veterans Memorial (2001)

39.036728,-95.652704

Section 96

The memorial (Figure 12) consists of two metal frames. The smaller east frame holds a large metal bell. Three flagpoles and two stone benches are located east of the frame. The larger west frame also hold a large metal bell suspended above a brick planter. A plaque in the center portion of the planter reads: BELL TOWER/ IS DEDICATED TO/ VIETNAM VETERANS/ BY AMERICAN LEGION/ CAPITOL POST NO. 1/ AND TOPEKA CEMETERY. A smaller plaque below reads: REDEDICATED JULY 4, 2003/ BY VIETNAM VETERANS/ OF AMERICA/ CHAPTER 604/ TOPEKA, KANSAS.

The memorial was erected in honor of Michael Bowen, who served in the Vietnam conflict and died in 2001. Lighting was added for the flags in 2016.

17. Columbarium (ca. 2005)

39.037558,-95.652138

Section 99

The cemetery's metal columbarium (Figure 13) is an irregularly shaped structure placed on a hexagonal concrete pad. The U-shaped structure has eight sides, each with six horizontal niches for interment of cremains. The structure is approximately eight feet tall.

The structure, designed by local sculptor Dave Stevens, was built around 2005.

⁶ "Kansans in Chicago," *Kansas Magazine*, November 1901.

Topeka Cemetery (Boundary Expansion)
Name of Property

Shawnee County, Kansas
County and State

18. Garden Chapel (ca. 1995)

39.037324,-95.652148

Section 99

Eight wooden posts support the square open-air structure (Figure 13). Each side has short walls and lattice arches between each post. A cupola tops the pyramidal roof.

The structure was a gift from the Hummers, completed in the mid-1990s.

19. 1966 Tornado Memorial (built 1967; relocated 1996)

39.037412,-95.652524

Section 99

The metal white cross is 38 feet tall (Figure 15). It sits on a concrete base atop a round concrete pad. The base contains two plaques—one that lists the names of the 16 victims of the June 1966 tornado and one that honors Nancy Hummer, who died August 12, 1966.⁷

The cross was originally erected on Burnett's Mound, Topeka's highest point, on June 2, 1967. It honored those killed on June 8, 1966 when a tornado swept through Topeka. The cross was frequently vandalized in that location, so Topeka Cemetery Board members moved it here around 1996.⁸ This structure was a gift from the Hummers; Dana Hummer was Topeka police chief when the tornado struck.

Integrity

The Topeka Cemetery retains its pastoral appearance and much of its original feeling conveyed by the planned paths, view corridors within the cemetery, historic markers, mausolea and adjacent farmstead buildings. The cemetery's initial 45 acres and 1915 expansion to its current 77 acres of gravesites, markers, walkways and roads remain intact. The historic spatial relationships between burial areas, buildings and structures are still present, demonstrating the cemetery's integrity. Current interments continue to follow patterns previously established within the cemetery and do not detract from the cemetery's historic significance. The non-contributing structures are clustered in the south portion of the site and do not affect the cemetery's integrity. The site retains integrity of location, setting, feeling, design and materials.

The Topeka Cemetery continues to operate as a privately owned burial ground governed by a board of directors. The cemetery is well-maintained. Most markers and gravesites are intact and convey their significance of age, associations and information.

⁷ The tornado victims listed are not buried in Topeka Cemetery.

⁸ Dick King, "Q & A: Burnett's Mound cross now at cemetery," *The Topeka Capital-Journal*, 25 January 2004. Accessed at http://cjonline.com/stories/012504/col_qna.shtml#.WH_FF7YrK3U.

Topeka Cemetery (Boundary Expansion)
Name of Property

Shawnee County, Kansas
County and State

8. Statement of Significance

Applicable National Register Criteria

(Mark "x" in one or more boxes for the criteria qualifying the property for National Register listing.)

- A Property is associated with events that have made a significant contribution to the broad patterns of our history.
- B Property is associated with the lives of persons significant in our past.
- C Property embodies the distinctive characteristics of a type, period, or method of construction or represents the work of a master, or possesses high artistic values, or represents a significant and distinguishable entity whose components lack individual distinction.
- D Property has yielded, or is likely to yield, information important in prehistory or history.

Criteria Considerations

(Mark "x" in all the boxes that apply.)

Property is:

- A Owned by a religious institution or used for religious purposes.
- B removed from its original location.
- C a birthplace or grave.
- D a cemetery.
- E a reconstructed building, object, or structure.
- F a commemorative property.
- G less than 50 years old or achieving significance within the past 50 years.

Areas of Significance

Exploration and Settlement

Architecture

Period of Significance

1859-1959

Significant Dates

1859

1915

Significant Person

(Complete only if Criterion B is marked above.)

N/A

Cultural Affiliation

N/A

Architect/Builder

Crane, Franklin (Builder)

Period of Significance (justification)

The Topeka Cemetery's period of significance is 1859 to 1959. The period includes the initial platting of the cemetery to the year that the Crane family sold the cemetery.

Topeka Cemetery (Boundary Expansion)

Shawnee County, Kansas

Name of Property

County and State

Criteria Considerations (justification)

The cemetery meets special requirements for Criteria Consideration D, as it reflects important aspects of Topeka's history and includes the graves of many early Kansas and Topeka leaders. The cemetery is the final resting place of four Kansas governors—Samuel J. Crawford, George T. Anthony, John A. Martin and Arthur Capper.⁹ Charles Curtis, the 31st Vice President of the United States, is also buried there. Other notable burials include Cyrus K. Holliday, founder of the Atchison, Topeka & Santa Fe Railway, which was Topeka's largest employer for half a century; Dr. D.W. Stormont, founder of a Topeka hospital; James Edwin Hurley, general manager of the Atchison, Topeka, Santa Fe Railway; Edward McCabe, Kansas Auditor and the first African-American to hold a statewide office in a northern state. Among the many other important Topeka families is the Crane family, an eight-generation line of Topekans. Dr. Crane funded the construction of the first bridge across the Kansas River, supplied the building site for the first Santa Fe shops and served as recorder of deeds for the new Topeka Town Association.¹⁰

The cemetery also meets the Criteria Consideration D as it embodies the principles of both the Rural Cemetery and Lawn-Park Cemetery movements.¹¹

⁹ Arthur Capper also served as a U.S. Senator from 1919 to 1949.

¹⁰ National Register Bulletin 41, "Guidelines for Evaluation and Registering Cemeteries and Burial Places," 17. A cemetery is eligible if it derives its primary significance from graves of persons of transcendent importance, from age, from distinctive design features, or from association with historic events.

¹¹ National Register Bulletin 41, "Guidelines for Evaluation and Registering Cemeteries and Burial Places," 17.

Topeka Cemetery (Boundary Expansion)

Shawnee County, Kansas

Name of Property

County and State

Narrative Statement of Significance

Summary

The Topeka Cemetery Historic District nomination amends the Topeka Cemetery Mausoleum Row National Register listing to include the entire cemetery and extant buildings historically associated with the cemetery. The previously listed buildings are significant under Criterion C for Architecture. The amended nomination adds Criterion A due to the cemetery's local significance in the area of Exploration and Settlement for its association with early Topeka. The Topeka Cemetery, platted by Franklin Crane in 1859 east of the four-year-old city, is Kansas' oldest chartered cemetery and remains active today. The amended nomination of the entire cemetery is also locally significant under Criterion C as an outstanding example of a planned landscape that combines two periods of cemetery design—19th-Century rural design and a 20th-Century lawn-park landscape. The earliest portion of the cemetery features winding paths on hilly terrain, prominent memorials, markers that incorporate Victorian-era iconography and cohesive family plots with matching headstones, all elements of rural cemetery design. The later, southern, portion of the cemetery presents an orderly assemblage of large markers and paths that reflect the Classical formality made popular by the City Beautiful movement. Mausolea in both portions are styled in the Greek Revival, Classical Revival, Beaux Arts and Egyptian Revival styles. Topeka Cemetery's period of significance is 1859-1959. The period includes the initial platting of the cemetery to the year that the Crane family sold the cemetery.

Elaboration

History

In the winter of 1854, Cyrus K. Holliday and Charles Robinson traveled 25 miles west of Lawrence along the Kansas River in search of a new town site for a second Kansas colony. They were looking for a site close to river transportation and an appropriate distance from the town of Lawrence. Upon finding an ideal location on a low bluff that would accommodate a wharf, they convinced other members of the New England Emigrant Aid Company to form a town company. The group agreed on the name of Topeka for the new town. The Territorial Legislature incorporated Topeka as a city on February 14, 1857. The town's population reached 450 that year with several citizens moving there from the nearby diminishing town of Tecumseh. When the county seat was transferred from Tecumseh to Topeka, Topeka's population rose to 512 in 1858.¹² On March 26, 1861, the State Legislature passed an act designating Topeka as the permanent location of the State capital.¹³

Dr. Franklin Crane, (Figure 9) a dentist, arrived in Kansas in 1854. Crane was an abolitionist who firmly opposed the expansion of slavery into Kansas Territory. As a participant in the Free State Party, he was determined to make Topeka a prosperous and productive community. Crane wrote in his diary on April 19, 1855 that he had bought his claim near Topeka for \$100. He hired a carpenter, purchased lumber and supplies and commenced building a house. The carpenter, Mr. Zimmerman, was paid \$65.33 for his work. Dr. Crane was elected to the Topeka Town Association in January 1856.¹⁴ In 1859 he served as president of the Topeka city council and then became mayor.

Early Topekans were buried in rural plots or in the town's earliest cemetery at the southeast corner of 10th Street and Kansas Avenue. The town fathers realized they did not want a cemetery in the middle of town and began looking for another site. Crane, an avid spiritualist, offered his property on a hill east of Topeka. "If we can have a cemetery by no other means, I will start one myself," Crane wrote to Cyrus K. Holliday.¹⁵

¹² James R. Shorridge, *Cities on the Plains* (Lawrence: University of Kansas Press, 2004), 73.

¹³ William G. Cutler, *History of the State of Kansas* (Chicago: A.T. Andreas, 1883). Accessed online at <http://www.kancoll.org/books/cutler/shawnee/shawnee-co-p1.html#TOC>.

¹⁴ "Diary, Franklin L. Crane." <http://www.kansasmemory.org/item/11367>

¹⁵ Debra Hiebert, *Stories In Stone* (Topeka: Shawnee County Historical Society, 1998), 13.

Topeka Cemetery (Boundary Expansion)

Shawnee County, Kansas

Name of Property

County and State

The Topeka Cemetery had shareholders that included Dr. Crane, A.F. Whiting, Joseph C. Miller and other prominent Topekans. These shareholders wanted a formal charter for the cemetery, with articles of incorporation for its structure and planned operations. Since Territorial Kansas had no general incorporation laws, it was necessary to obtain charter authorization through an act of the legislature. Cyrus K. Holliday noted that on February 2, 1859, all rules were suspended during the legislative session for the passage of his charter for the Santa Fe Railroad.¹⁶ Crane also procured a charter for "The Topeka Cemetery" on February 2, 1859 from the territorial governor and legislative assembly of the Kansas Territory.

All cemetery duties were soon turned over to Crane, who platted the grounds, laid out drives and planted trees and shrubs. The grounds were opened for use in the spring of 1859.¹⁷ According to Topeka Cemetery records, Elias Kempton and Charles Wright, two children, were buried on December 9 and 10, 1859 in Section 7. Mrs. Marcia Gordon was buried on December 17, 1859 in Section 2.¹⁸ Within two years, the bodies buried at 10th and Kansas avenues, were exhumed and reinterred at the cemetery, with expenses shared by the individual families and the city.¹⁹ Crane's farmstead (Photo 4) soon grew to include a carriage house that also held a cemetery office. Crane's original small house was expanded and clad in stone, probably designed by architect Seymour Davis between 1880 and 1885 (Figures 4 & 5). The cemetery grounds were home to members of the Crane family through 1959. A second house was built for David O. Crane, who ran the cemetery after his father's death in 1884. It was razed in the late 1980s.

In 1873, several Topeka Jewish families formed the Katish and Bicorchowlin Society (K & BC Society) to purchase and lay out a cemetery. The organization purchased one acre adjoining the Topeka Cemetery on March 15, 1873 for \$300. The earliest burial in the section was Jonah Wise in 1874.²⁰ The acre was transferred from the surviving members of the K & BC Society to the Chevroh Kedishe and Bicor Chowlin Cemetery Association in November 1902.²¹ The Temple Beth Sholom retains ownership of the Jewish Cemetery today.

On October 19, 1877 the Topeka Cemetery created a new charter. George D. Hale was elected president and Dr. F.L. Crane became the secretary and treasurer. After Dr. Crane's death in 1884 and interment in the cemetery he founded, his sons, David O. and George W. Crane, were elected to the Board of Directors. David Crane became the cemetery superintendent. In 1909, the cemetery association adopted the Perpetual Care Plan, putting 10 percent of the sale price of every lot into a special fund to provide lasting maintenance capital.²² The 1873 and 1898 Shawnee County atlases show the Topeka Cemetery as 45 acres in the northeast corner of Section 5, Township 12 South, Range 16 East. The 1898 atlas also outlines the borders of the Hebrew Cemetery (Figures 6 & 7).

In 1881, the Topeka Cemetery donated ground containing 286 spaces in Section 21 for the burial of pauper Civil War soldiers. The Lincoln Post No. 1 of the Grand Army of the Republic, a veterans' group organized in Topeka, requested the donation of the land. The first burial in the Veteran Plat was in 1883.²³ The prominent Battle of the Blue "Gage" monument was unveiled in 1895 adjacent to the Plat. The monument was erected by G.G. Gage and dedicated to soldiers who died during the Civil War, especially his fellow comrades who fell at the Battle of the Blue. The monument cost more than \$5000.²⁴

¹⁶ "Cyrus K. Holliday Collection," manuscript division, Kansas Historical Society. Accessed online at <https://www.kshs.org/p/kansas-historical-quarterly-the-birth-of-the-atchison-topeka-and-santa-fe-railroad-1/13184>.

¹⁷ "Topeka Cemetery Oldest," *The Topeka Daily Capital*, 25 August 1929.

¹⁸ Register of Interments, Topeka Cemetery ledger.

¹⁹ "Topeka Cemetery Oldest," *The Topeka Daily Capital*, 25 August 1929.

²⁰ Wise owned a boot and shoe store at 72 Kansas Avenue.

²¹ *Shawnee County Cemeteries, Volume I*, April 1973.

²² *The Topeka Daily Capital*, 50th Anniversary Edition, 25 August 1929.

²³ Marble markers were placed on 59 of 84 unmarked graves in 1988. The Federal Government paid for the markers, which were researched by Sarah McNeive, member of the Topeka Cemetery Board of Directors.

²⁴ *Topeka State Journal*, 30 May 1914.

Topeka Cemetery (Boundary Expansion)

Shawnee County, Kansas

Name of Property

County and State

Ten mausolea were erected into a hillside row between 1887 and around 1913. Each mausoleum was individually built.²⁵ Six additional mausolea were built between 1916 and 1930 in the south portion of the cemetery added in 1915.

The Topeka Cemetery expanded southward in 1915 when 45 acres were purchased.²⁶ Advertisements for the expanded grounds stated that the tract would soon be improved and lots sold on the Perpetual Care Plan. The 1921 *Kansas Farmer and Breeze* shows the cemetery as 90.28 acres (Figure 8). The city limits surrounded the cemetery when the City of Topeka annexed the area in 1958.

The Topeka Cemetery stayed in the Crane family until 1959, passing from David O. Crane to his children and grandchildren. In 1959, it was sold in error to William Weber, who then sold the cemetery to William Barr in 1968. On March 9, 1976, ownership of the cemetery was turned back over to lot owners.²⁷

Ramps and bridges connecting Interstate 70 to California Avenue claimed a section of land on the south edge of the cemetery in 1963, according to the Kansas Department of Transportation. Nearly 32 acres in the southwest portion of the cemetery became Freedom Valley Park in 1984.

The cemetery suffered from vandalism in the 1980s. In 1984, vandals overturned 100 headstones and broke 20. Mausolea were also damaged.²⁸ The wrought iron fence, built in 1996, now offers protection from intruders.

Since its beginning, the Topeka Cemetery has served as the burial ground for prominent citizens associated with Topeka and Kansas history. The cemetery is the final resting place of four Kansas governors—Samuel J. Crawford, George T. Anthony, John A. Martin and Arthur Capper, who went on to become a U.S. Senator. Twenty-two Topeka mayors are interred there.²⁹ Charles Curtis, the 31st Vice President of the United States, is also buried there. Other notable burials include Dr. D.W. Stormont, founder of a Topeka hospital; James Edwin Hurley, general manager of the Atchison, Topeka, Santa Fe Railway; Edward McCabe, the only African-American to ever hold statewide office in Kansas; Cyrus K. Holliday, who signed the town charter of Topeka and many other important Topeka families.

A nine-member Board of Directors now governs the Topeka Cemetery Association, which continues to be owned by the lot owners. Funds to pay staff and maintain the grounds come from the sale of burial plots, vaults and markers, fees charged for graveside services and burials and an annual stipend from the city of Topeka.

Cemetery Design

Franklin Crane embraced the ideals of the rural cemetery movement, which asserted the notion that cemeteries should offer a place to reflect on nature, life and death. Before the 19th century, most burials took place in churchyards, country family plots or urban squares, like the early cemetery at 10th Street and Kansas Avenue. During the later 1800s, attitudes toward death began to change. Man was presented as a part of nature, destined to join nature after death. Death was described by writers, such as William Cullen Bryant, as part of the cycle of nature. During this era, the realization also arose that corpses could be a source of contagion and should be buried far from dwellings. Inspired by the writings of the era, civic leaders in the early

²⁵ National Register, April 25, 2001.

²⁶ "Topeka Cemetery To Be Enlarged," *The Topeka Daily Capital*, 18 April 1915, 22.

²⁷ "Crane family in control until 1959," *Topeka Capital Journal*, 2 April 2009. The error was that the original charter did not permit the cemetery to be a for-profit enterprise.

²⁸ "Topeka Cemetery board offers reward," *Topeka Capital Journal*, 6 September 1984, 2.

²⁹ Jan Biles, "Topeka Cemetery marks 150th anniversary," *Topeka Capital Journal*, 1 February 2009.

Topeka Cemetery (Boundary Expansion)

Shawnee County, Kansas

Name of Property

County and State

19th century strove to create idyllic settings for cemeteries away from town centers. This movement replaced cramped urban plots with rural verdant gardens. Instead of rigid grounds with rows of markers, the new cemeteries would have park-like settings with lush foliage, mature trees and plantings that surrounded the headstones and statues.³⁰

Rural cemeteries were deliberately located outside of cities, so burial plots could be larger. In turn, markers could also be larger and more elaborate than ever before. The country's first rural cemetery, Mount Auburn in Boston, Massachusetts, was founded in 1832. Following its development were Laurel Hill Cemetery in Philadelphia, Pennsylvania (1836), Greenwood Cemetery in New York City (1838), Spring Grove Cemetery in Cincinnati, Ohio (1845), and Magnolia Cemetery in Charleston, South Carolina (1850). These cemeteries became the prototypes and inspiration for others, such as the Topeka Cemetery. The settings and scenery made the cemeteries popular destinations for weekend outings.³¹

Franklin Crane planned the earliest portion of the Topeka Cemetery as a rural cemetery. Here a family could be buried in adjacent plots and visitors could enjoy nature. The location away from the city would also allow Topeka to grow to its borders.³² In planning the cemetery, Crane laid out winding drives and planted trees and shrubs. The cemetery was praised by the *Topeka State Journal* in 1914:

The Topeka cemetery undoubtedly has more beautiful monuments and private vaults than that possessed by any other city the size of Topeka in the country. Many prominent landscape artists have pronounced the general plat of the Topeka cemetery to be the best arranged of any cemetery in the country. Acres of beautiful ground have been given to make the cemetery a restful landscape and this was the idea Dr. Crane had in laying out the original plans for the cemetery.³³

The 1915 expansion of the Topeka Cemetery provided an orderly layout of rectangular sections and roads, harmonious with the lawn-park cemetery style. The lawn-park movement offered a less crowded, neater landscape than the earlier rural cemetery. These cemeteries were most popular from the late 1800s to the 1920s. The first planned lawn-park cemetery was the 1854 Spring Grove Cemetery in Cincinnati, Ohio. The views within this cemetery consisted of open, well-tended grass lawns.³⁴

The lawn-park movement fully emerged as graveyard operations underwent a nationwide shift. Cemeteries began offering perpetual care through the purchase of plots offered with services. The orderly layout accommodated cemetery maintenance crews operating new machinery, such as power lawn mowers. The newly industrialized business of designing, cutting and assembling granite tombstones promoted a landscape of smaller, more uniform and less sculptural markers. These advances were all in keeping with a new visual balance between formalism and nature.³⁵

The southern lawn-park portion of the Topeka Cemetery is an excellent early example of this type in Kansas. It has open, organized sections with rows of markers oriented to the roads. Most markers are rectangular stones, either freestanding or set at ground level. Mausolea are located at three intersections within circular median islands.

³⁰ Marilyn Yalom, *The American Resting Place: 400 Years of History Through Our Cemeteries and Burial Grounds* (Boston: Houghton Mifflin Co., 2008), 44-45.

³¹ Sherry Piland, "Elmwood Cemetery" *National Register of Historic Places Inventory-Nomination Form*, 17 February 1983, 7-8

³² Debra Hiebert, *Stories In Stone* (Topeka: Shawnee County Historical Society, 1998), 7.

³³ "Honor The Dead," *Topeka State Journal*, 30 May 1914.

³⁴ Keith Eggener, *Cemeteries* (New York: W.W. Norton, 2010), 106.

³⁵ "Cemetery Preservation and Recordation," Pennsylvania Historical and Museum Commission, accessed 20 February 2017, <http://www.phmc.state.pa.us/portal/communities/cemetery-preservation/development/1900-present.html>

Topeka Cemetery (Boundary Expansion)

Name of Property

Shawnee County, Kansas

County and State

Conclusion

The Topeka Cemetery is locally significant under Criterion A in the area of Exploration and Settlement as the oldest chartered cemetery in Kansas. The cemetery is also locally significant under Criterion C as an example of a planned cemetery landscape. The cemetery also meets special requirements for Criterion D due to the interment of many early city and state leaders, such as four Kansas governors—Samuel J. Crawford, George T. Anthony, John A. Martin and Arthur Capper—and Charles Curtis, the 31st Vice President of the United States and as an example of a designed landscape.

The landscape and headstones continue to convey associations with the settlement of Topeka and the historic cemetery design. The Topeka Cemetery retains its integrity, especially in location, setting, feeling, design and materials. It retains much of its original layout and a density of historic markers that range from simple gravestones to elaborate Victorian-era monuments to modern markers. The landscape contributes to the historic scenery representing its period of significance from 1859 to 1959.

Topeka Cemetery (Boundary Expansion)

Shawnee County, Kansas

Name of Property

County and State

9. Major Bibliographical References

Bibliography (Cite the books, articles, and other sources used in preparing this form.)

- Atlas of Shawnee County*. New York: F.W. Beers, 1873. (Accessed online at <http://kshs.org/p/property-ownership-maps-or-plat-books/13859#s>).
- Atlas of Shawnee County, Kansas*. Topeka: Kansas Farmer & Mail & Breeze, ca. 1921.
- Biles, Jan. "Topeka Cemetery marks 150th anniversary." *Topeka Capital Journal*, 1 February 2009.
- "Burial Ground Here May be only One of Kind in State." *Topeka State Journal*, 18 February 1950.
- "Crane family in control until 1959." *Topeka Capital Journal*, 2 April 2009.
- Cutler, William G. *History of the State of Kansas*. Chicago: A.T. Andreas, 1883. Accessed online at <http://www.kancoll.org/books/cutler/shawnee/shawnee-co-p1.html#TOC>.
- "Cyrus K. Holliday Collection," manuscript division, Kansas Historical Society. Accessed online at <https://www.kshs.org/p/kansas-historical-quarterly-the-birth-of-the-atchison-topeka-and-santa-fe-railroad-1/13184>.
- "Diary, Franklin L. Crane." <http://www.kansasmemory.org/item/11367>
- Eggener, Keith. *Cemeteries*. New York: W.W. Norton, 2010.
- Hiebert, Debra. *Stories In Stone*. Topeka: Shawnee County Historical Society, 1998.
- "Honor The Dead." *Topeka State Journal*, 30 May 1914.
- "The Hurley Monument." *Santa Fe Employes' Magazine*. March 1912.
- "Kansans in Chicago." *Kansas Magazine*, November 1901.
- King, Dick. "Q & A: Burnett's Mound cross now at cemetery." *The Topeka Capital-Journal*, 25 January 2004. Accessed at http://cjonline.com/stories/012504/col_qna.shtml#.WH_FF7YrK3U.
- Meinhardt, Chris. "Topeka Cemetery Mausoleum Row." *National Register of Historic Places Nomination*. 1 March 2001.
- Pennsylvania Historical and Museum Commission. "Cemetery Preservation and Recordation." Accessed 20 February 2017. <http://www.phmc.state.pa.us/portal/communities/cemetery-preservation/development/1900-present.html>.
- Piland, Sherry. "Elmwood Cemetery" *National Register of Historic Places Inventory-Nomination Form*, 17 February 1983.
- Register of Interments, Topeka Cemetery ledger. Topeka Cemetery Archives.
- Shawnee County Cemeteries, Volume I*, April 1973.
- Shortridge, James R. *Cities on the Plains*. Lawrence: University of Kansas Press, 2004.
- Standard Atlas of Shawnee County, Kansas*. Chicago: George A. Ogle & Co., 1898.
- "Thousands Due to Visit Oldest Cemetery May 30." *Topeka State Journal*, 29 May 1939.
- Topeka Cemetery Association. "Historic Topeka Cemetery." Unpublished Cemetery Brochure. 2016.
- "Topeka Cemetery board offers reward." *Topeka Capital Journal*, 6 September 1984.
- "Topeka Cemetery Oldest." *The Topeka Daily Capital*, 25 August 1929.
- "Topeka Cemetery To Be Enlarged." *The Topeka Daily Capital*, 18 April 1915.
- The Topeka Daily Capital*. 50th Anniversary Edition, 25 August 1929.
- Topeka State Journal*. 30 May 1914.
- Yalom, Marilyn. *The American Resting Place: 400 Years of History Through Our Cemeteries and Burial Grounds*. Boston: Houghton Mifflin Co., 2008.

Previous documentation on file (NPS):

Primary location of additional data:

Topeka Cemetery (Boundary Expansion)
Name of Property

Shawnee County, Kansas
County and State

preliminary determination of individual listing (36 CFR 67 has been requested)
 previously listed in the National Register
 previously determined eligible by the National Register
 designated a National Historic Landmark
 recorded by Historic American Buildings Survey # _____
 recorded by Historic American Engineering Record # _____
 recorded by Historic American Landscape Survey # _____

State Historic Preservation Office
 Other State agency
 Federal agency
 Local government
 University
 Other
Name of repository: The Topeka Cemetery

Historic Resources Survey Number (if assigned): _____ N/A

10. Geographical Data

Acreage of Property 77.76 acres

Provide latitude/longitude coordinates OR UTM coordinates.
(Place additional coordinates on a continuation page.)

A	<u>39.044180</u>	<u>-95.655460</u>	C	<u>39.035800</u>	<u>-95.651220</u>
	Latitude:	Longitude:		Latitude:	Longitude:
B	<u>39.044180</u>	<u>-95.650850</u>	D	<u>39.035930</u>	<u>-95.65403</u>
	Latitude:	Longitude:		Latitude:	Longitude:

Verbal Boundary Description (describe the boundaries of the property)

The roughly rectangular cemetery is located in the eastern portion of Topeka, bounded on the north by Southeast 10th Avenue, on the east by Southeast California Avenue, on the south by a highway ramp and on the west by the property line and Freedom Valley Park. The property's legal description, as provided by the county, is: S05, T12, R16E, BEG AT A PT 30 W AND 30 S OF NE COR NW 1/4 S 2866.89 W 10 SW 250.8 NW 209.69 NW 355.96 NW 124.82 NW 120.7 3 N 384.66 W 130(S) N 122.46 NW 74 (PID: 133-05-0-10-01-001.00-0).

Boundary Justification (explain why the boundaries were selected)

The boundaries include the extant grounds originally platted in 1859 and 1915 as the Topeka Cemetery.

11. Form Prepared By

name/title Susan Jezak Ford
organization Citysearch Preservation date March 2017
street & number 3628 Holmes Street telephone 816-531-2489
city or town Kansas City state Missouri zip code 64109
e-mail citysusan@gmail.com

Property Owner: (complete this item at the request of the SHPO or FPO)

name Topeka Cemetery Association
street & number 1601 SE 10th Avenue telephone 785-233-4132
city or town Topeka state Kansas zip code 66607

Paperwork Reduction Act Statement: This information is being collected for applications to the National Register of Historic Places to nominate properties for listing or determine eligibility for listing, to list properties, and to amend existing listings. Response to this request is required to obtain a benefit in accordance with the National Historic Preservation Act, as amended (16 U.S.C.460 et seq.).

Estimated Burden Statement: Public reporting burden for this form is estimated to average 100 hours per response including time for reviewing instructions, gathering and maintaining data, and completing and reviewing the form. Direct comments regarding this burden estimate or any aspect of this form to the Office of Planning and Performance Management, U.S. Dept. of the Interior, 1849 C. Street, NW, Washington, DC.

Topeka Cemetery (Boundary Expansion)
Name of Property

Shawnee County, Kansas
County and State

Additional Documentation

Submit the following items with the completed form:

Photographs

Submit clear and descriptive photographs. The size of each digital image must be 1600x1200 pixels (minimum), at 300 ppi (pixels per inch) or larger. Key all photographs to a sketch map or aerial map. Each photograph must be numbered and that number must correspond to the photograph number on the photo log. For simplicity, the name of the photographer, photo date, etc. may be listed once on the photograph log and doesn't need to be labeled on every photograph.

Photograph Log

Name of Property: Topeka Cemetery

City or Vicinity: Topeka

County: Shawnee State: Kansas

Photographer: Brad Finch

Date
Photographed: 1 December 2016

Description of Photograph(s) and number, include description of view indicating direction of camera:

- 1 of 23: Franklin Crane House; camera pointed to NE.
- 2 of 23: Cemetery Office/Carriage House; camera pointed to SW.
- 3 of 23: Cemetery Barn; camera pointed to SW.
- 4 of 23: Crane/Cemetery Farmstead; camera pointed to NW.
- 5 of 23: Hurley Monument, Mausoleum Row; camera pointed to NE.
- 6 of 23: Battle of the Blue Memorial, veterans plat; camera pointed to NE.
- 7 of 23: Dagg, Parker Mausolea; camera pointed to NW.
- 8 of 23: Stansfield Mausoleum; camera pointed to NW.
- 9 of 23: Hurd Mausoleum; camera pointed to SE.
- 10 of 23: Fulton Mausoleum; camera pointed to SE.
- 11 of 23: Battey Mausoleum; camera pointed to SW.
- 12 of 23: Jewish Cemetery; camera pointed to NW.
- 13 of 23: Entrance to Pet Cemetery; camera pointed to N.
- 14 of 23: Section 68 in N portion of cemetery; camera pointed to NW.
- 15 of 23: Section 1 in central portion of cemetery; camera pointed to SE.
- 16 of 23: Section 8 in central portion of cemetery; camera pointed to SW.
- 17 of 23: Section 13 in central portion of cemetery; camera pointed to NE.
- 18 of 23: Section 10 in central portion of cemetery; camera pointed to NW.
- 19 of 23: Section 73 in NE portion of cemetery; camera pointed to NE.
- 20 of 23: Section 90 in S portion of cemetery; camera pointed to SW.
- 21 of 23: Section 83 in S portion of cemetery; camera pointed to NE.
- 22 of 23: Section 90 in S portion of cemetery; camera pointed to N.
- 23 of 23: Cemetery's north main gate; camera pointed to S.

Figures

Include GIS maps, figures, scanned images below.

Topeka Cemetery (Boundary Expansion)

Shawnee County, Kansas

Name of Property

County and State

Figure 1. Topeka Cemetery location (Google Maps accessed 27 February 2017).

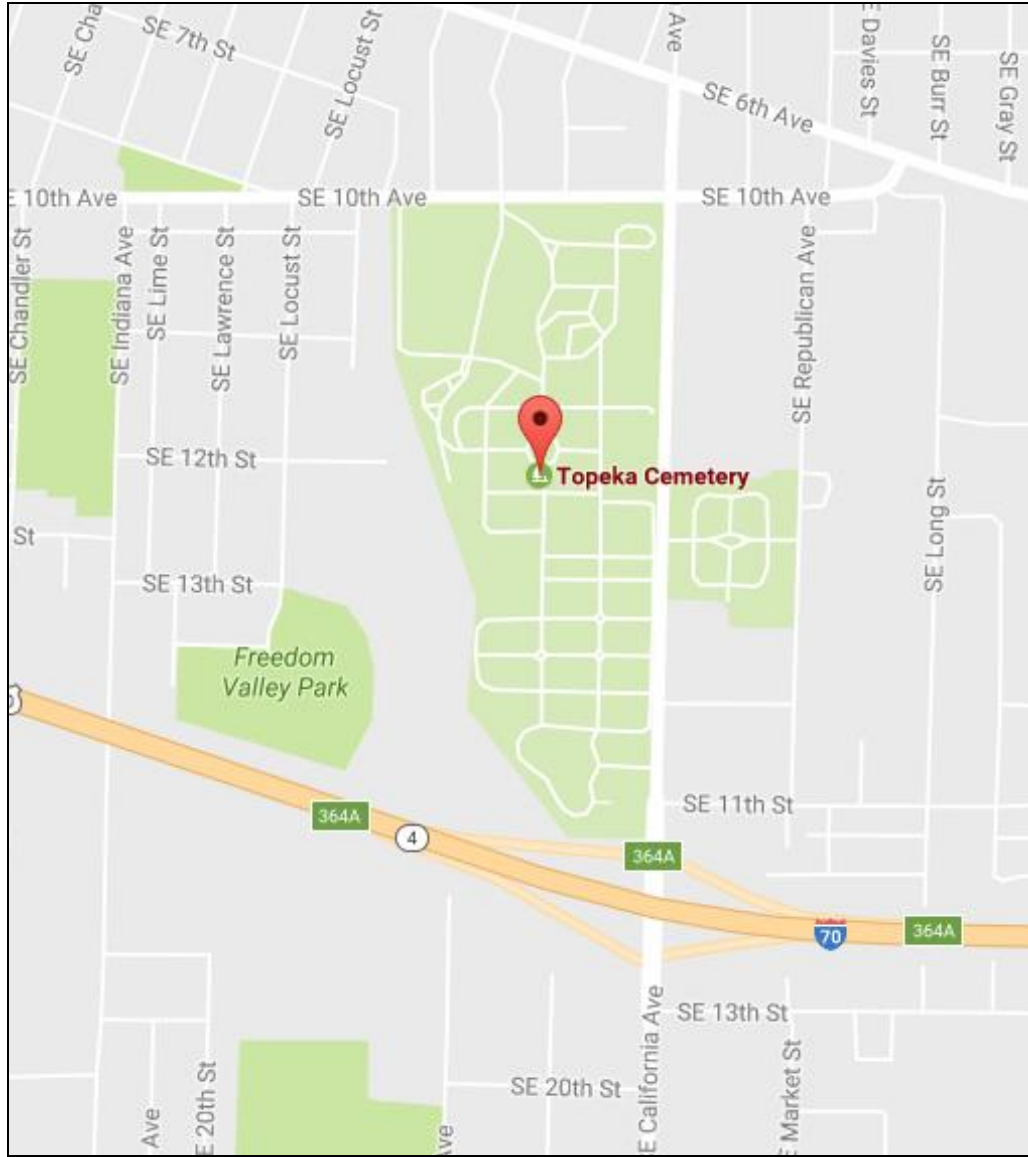

Topeka Cemetery (Boundary Expansion)

Shawnee County, Kansas

Name of Property

County and State

Figure 2. Sectional map of cemetery (Topeka Cemetery Association, "Historic Topeka Cemetery" brochure).

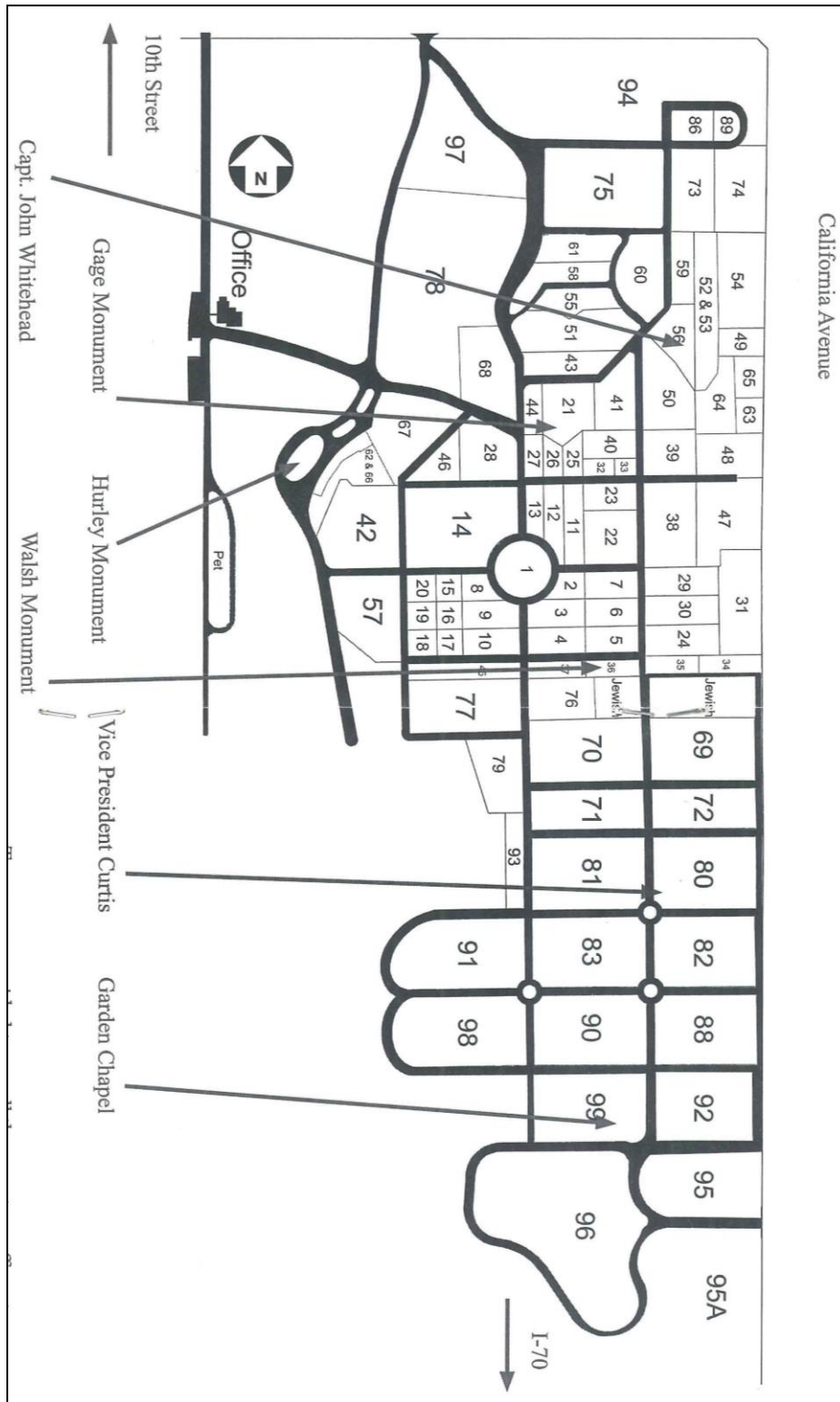

Topeka Cemetery (Boundary Expansion)

Shawnee County, Kansas

Name of Property

County and State

Figure 3. Cemetery features and photo locations.

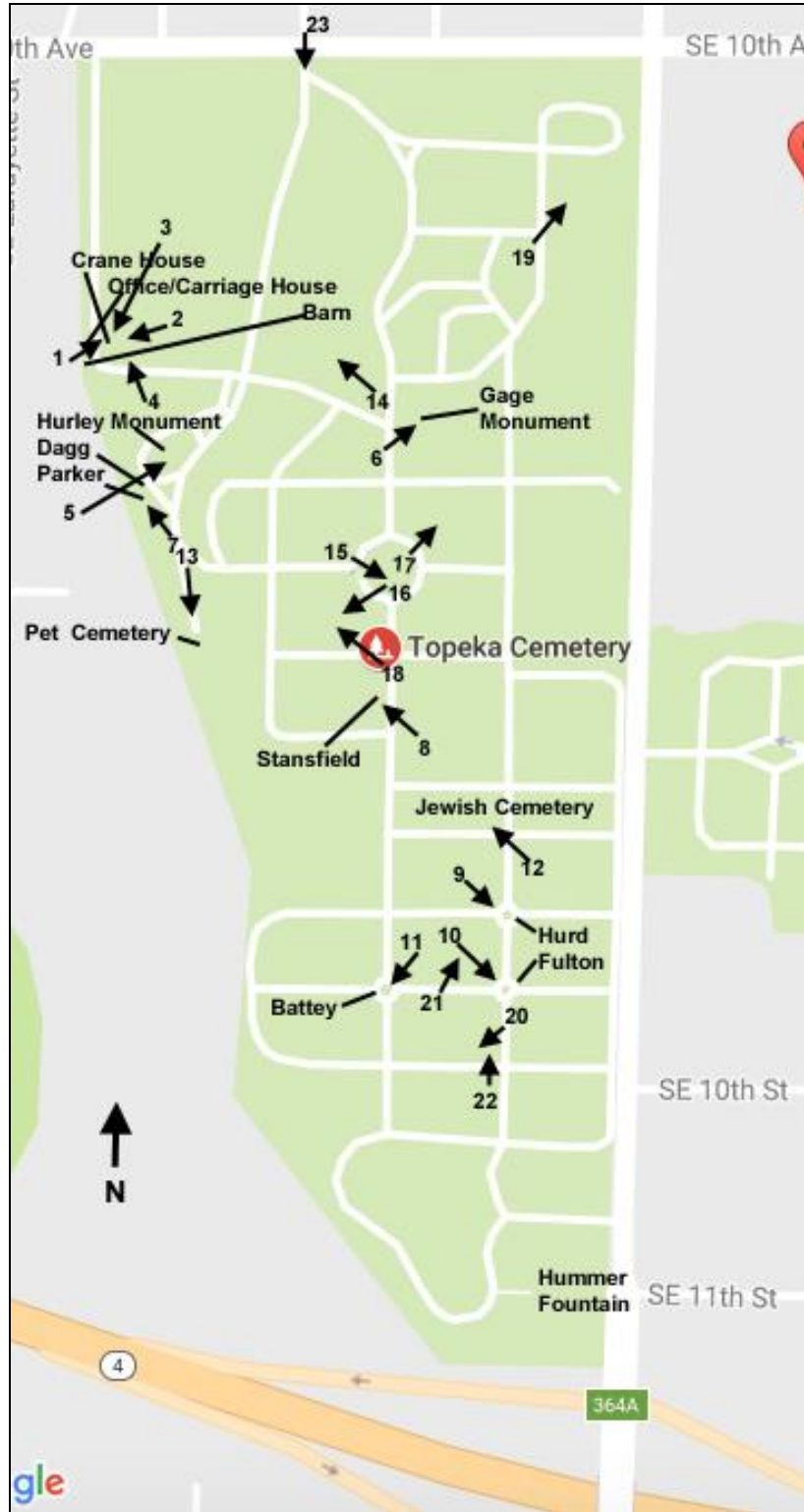

Topeka Cemetery (Boundary Expansion)
Name of Property

Shawnee County, Kansas
County and State

Figures 4 & 5. Topeka Cemetery farmstead in 1890 (top) and 1978 (bottom) (Cemetery archives).



Topeka Cemetery (Boundary Expansion)
Name of Property

Shawnee County, Kansas
County and State

Figure 8. 1921 Shawnee County atlas.



Topeka Cemetery (Boundary Expansion)
Name of Property

Shawnee County, Kansas
County and State

Figure 9. Franklin Crane (www.kansasmemory.org).

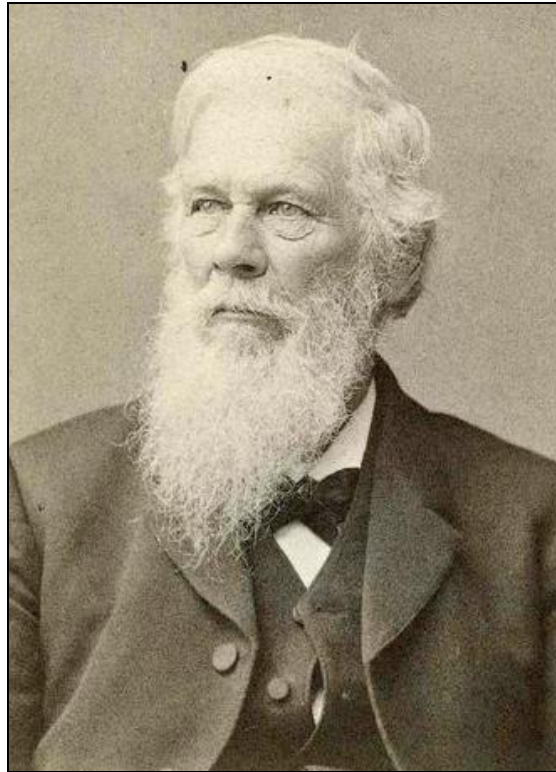

Figure 10. East boundary fence and driveway (Brad Finch).



Figure 11. Nancy Hummer Fountain (Susan Jezak Ford).

Topeka Cemetery (Boundary Expansion)
Name of Property

Shawnee County, Kansas
County and State



Figure 12. Vietnam Veterans Memorial (Susan Jezak Ford).



Topeka Cemetery (Boundary Expansion)

Shawnee County, Kansas

Name of Property

County and State

Figure 13. Columbarium (Susan Jezak Ford).



Figure 14. Garden Chapel (Susan Jezak Ford).



Topeka Cemetery (Boundary Expansion)
Name of Property

Shawnee County, Kansas
County and State

Figure 15. 1966 Tornado Memorial (Susan Jezak Ford).



Topeka Cemetery (Boundary Expansion)
Name of Property

Shawnee County, Kansas
County and State

Boundary Map. Cemetery boundaries and latitude/longitude coordinates (Shawnee County GIS).



May 11, 2017

Parcels

